

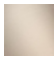

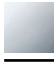



20 000 783

- Bohrungsdurchmesser 32 mm
- Rosette 60 x 60 mm
- mit Warmkennzeichnung



	Champagne gebürstet (22kt Gold)	20 000 783-46
	Chrom	20 000 783-00
	Platin gebürstet	20 000 783-06
	Platin	20 000 783-08
	Dark Chrome	20 000 783-19
	Messing gebürstet (23kt Gold)	20 000 783-28
	Champagne (22kt Gold)	20 000 783-47
	Dark Platinum gebürstet	20 000 783-99

20 000 783

mm [inches]

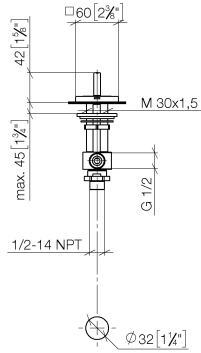

Durchflussdiagramm

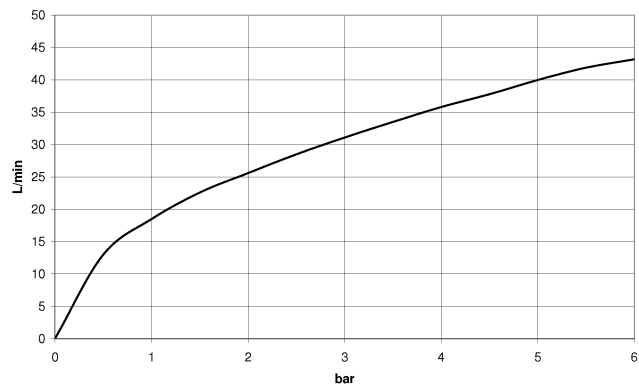

Zertifikate

WRAS_2103001.

20 000 783

Ersatzteile für die
anderen
Oberflächenvarianten
finden Sie hier:
Chrom

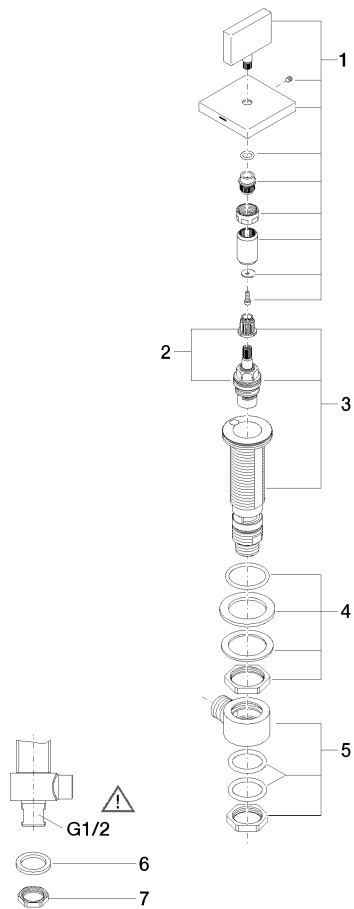

Ersatzteilstückliste

Nr.	Artikelnummer	Benennung	Verbaumenge	Lieferzeit
1	90 20 78 002 05-46	Griff (hot)	1	30
2	90 90 03 132 00 90	Oberteil	1	2
3	04 17 11 058 32 90	Seitenteil	1	2
4	04 23 10 032 78 90	Befestigungssatz	1	2
5	04 17 11 023 10 90	Verteiler	1	2
6	09 30 11 059 90	Scheibe	1	2
7	09 23 10 012 90	Mutter	1	2